

KTR-25			
Typ	Di +0,2	Da	Tragzahl C [daN]
KTR-40x3,0.25	37,3	39,9	50
KTR-50x1,5.25	47,3	49,9	50
KTR-50x2,8.25	44,6	49,9	50

**Weitere Varianten auf Anfrage!**

- ☛ Radkörper: Kunststoff
- ☛ Kugellager RL-25
  - ☛ Lagerschale: Stahl, gehärtet
  - ☛ Innenring: Stahl, gehärtet, verzinkt
  - ☛ Kugelkäfig: Kunststoff
  - ☛ Kugel: Stahl

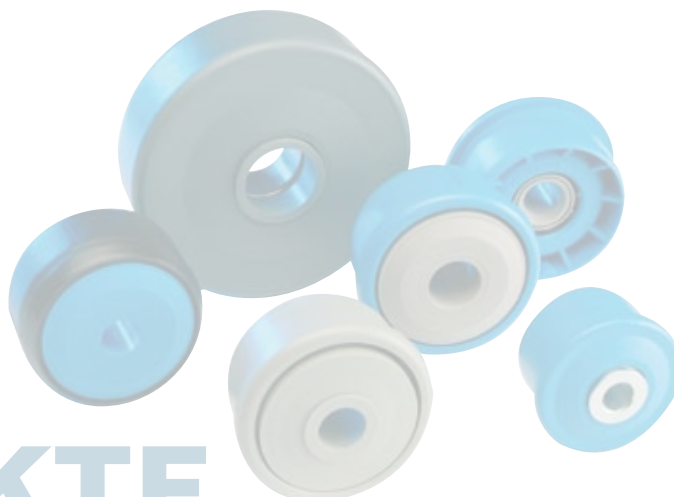

**KTR-25**

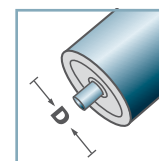

**D** [mm]  
40 - 50

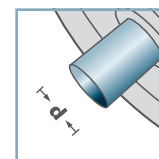

**d** [mm]  
8; 10; 12

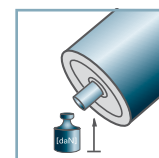

**C** [daN]  
50

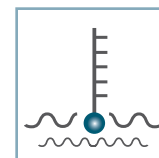

**T** [°C]  
0° - 80°



Vactra No. 2



**Karton** [Stck.]

ø40: 400  
ø50: 300

**KTR/KTE**

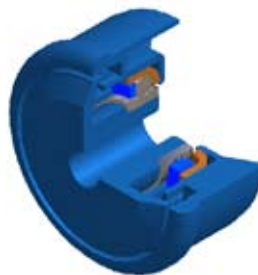
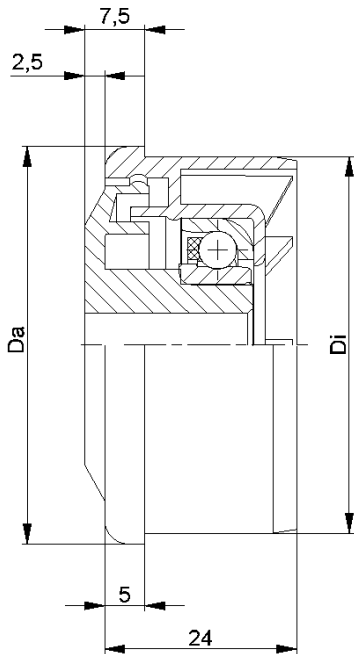

KTR-30			
Typ	Di +0,2	Da	Tragzahl C [daN]
KTR-50x1,5.30	47,3	49,9	80
KTR-50x2,8.30	44,6	49,9	80
KTR-60x1,5.30	57,3	59,9	80

**Weitere Varianten auf Anfrage!**

- ☛ Radkörper: Kunststoff
- ☛ Einfachlabyrinth: Kunststoff
- ☛ Kugellager RL-30
  - ☛ Lagerschale: Stahl, gehärtet
  - ☛ Innenring: Stahl, gehärtet
  - ☛ Kugelkäfig: Kunststoff
  - ☛ Kugel: Stahl

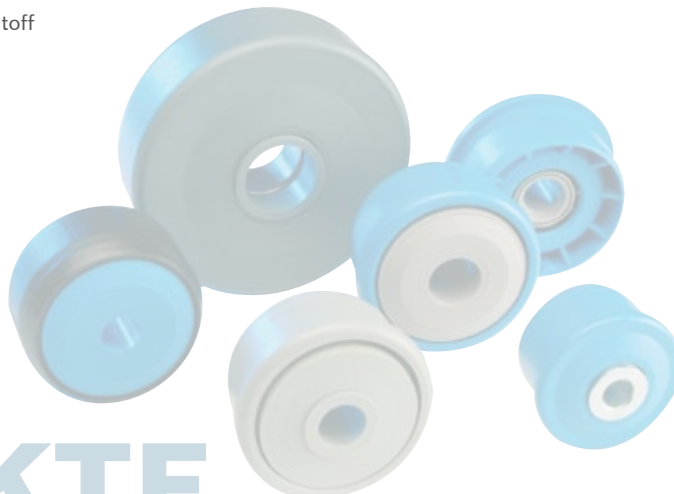

**KTR-30**

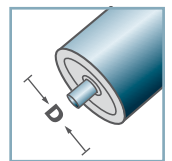

**D** [mm]  
50 - 60

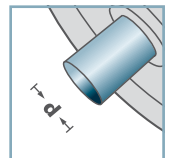

**d** [mm]  
10; 12; 14; 15;  
SW11



**C** [daN]  
80

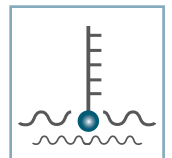

**T** [°C]  
0° - 80°



Vactra No. 2



**Karton** [Stck.]

250

**KTR/KTE**

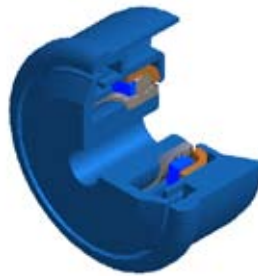
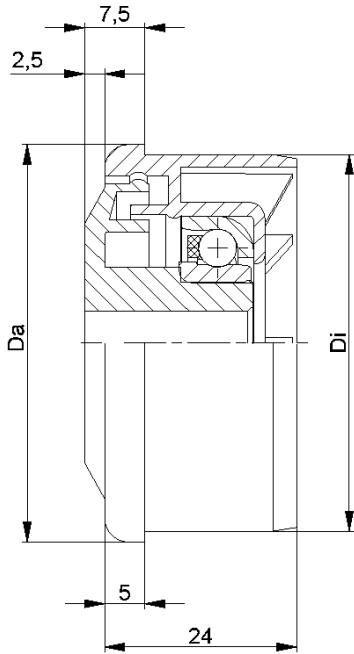

KTR-31			
Typ	Di +0,2	Da	Tragzahl C [daN]
KTR-50x1,5.31	47,3	49,9	25
KTR-50x2,8.31	44,6	49,9	25
KTR-60x1,5.31	57,3	59,9	25

**Weitere Varianten auf Anfrage!**

- ☛ Radkörper: Kunststoff
- ☛ Einfachlabyrinth: Kunststoff
- ☛ Kugellager RL-31
  - ☛ Lagerschale: 1.4301
  - ☛ Innenring: 1.4305
  - ☛ Kugelkäfig: Kunststoff
  - ☛ Kugel: 1.4301

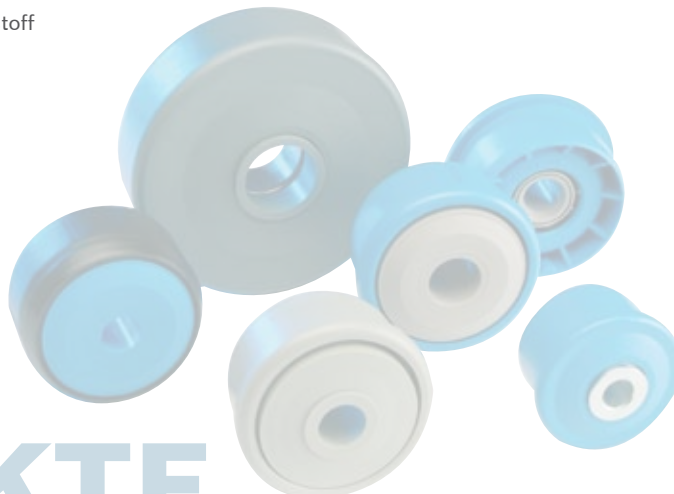

**KTR-31**

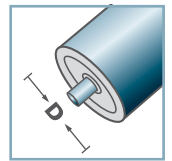

**D** [mm]  
50 - 60

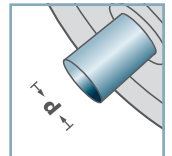

**d** [mm]  
10; 12; 14; 15;  
SW11



**C** [daN]  
25

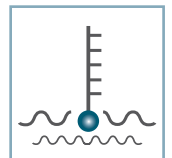

**T** [°C]  
0° - 80°



Vactra No. 2



**Karton** [Stck.]

250

**KTR/KTE**

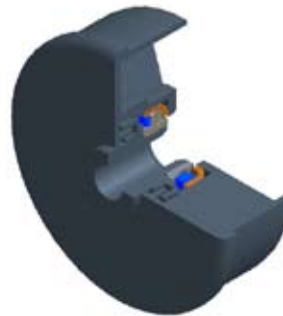
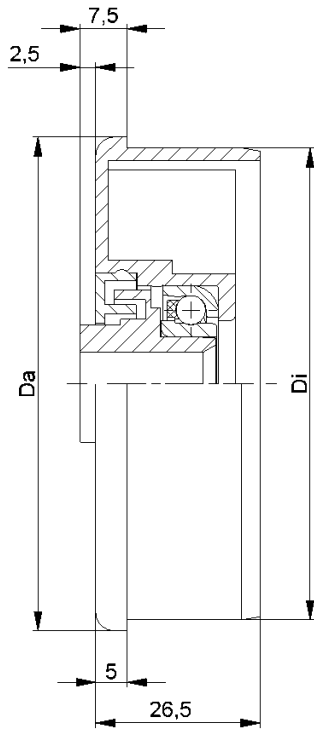

KTR-30			
Typ	Di +0,2	Da	Tragzahl C [daN]
KTR-80x2,0.30	76,3	79,9	80

**Weitere Varianten auf Anfrage!**

- ☛ Radkörper: Kunststoff
- ☛ Innenlabyrinth: Kunststoff
- ☛ Außenlabyrinth: Kunststoff
- ☛ Kugellager RL-30
  - ☛ Lagerschale: Stahl, gehärtet
  - ☛ Innenring: Stahl, gehärtet
  - ☛ Kugelkäfig: Kunststoff
  - ☛ Kugel: Stahl

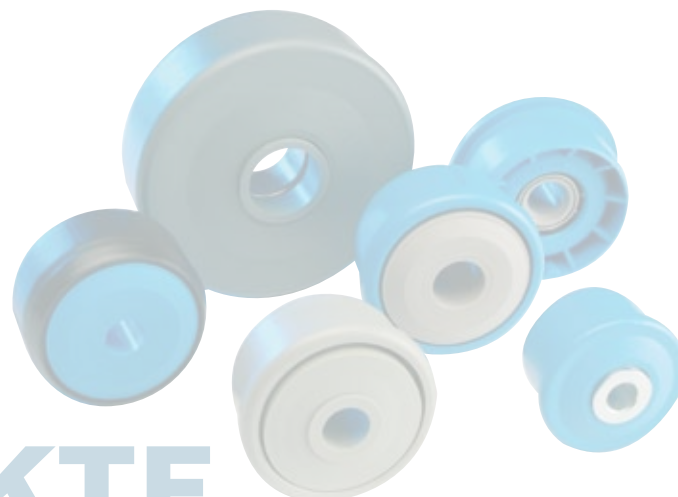

**KTR-30**

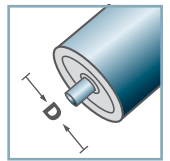

**D** [mm]  
80

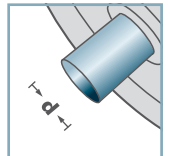

**d** [mm]  
12; 15; SW11



**C** [daN]  
80

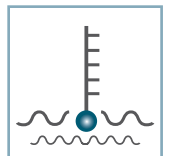

**T** [°C]  
0° - 80°



Vactra No. 2



**Karton** [Stck.]

100

**KTR/KTE**

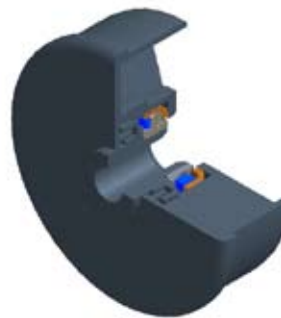
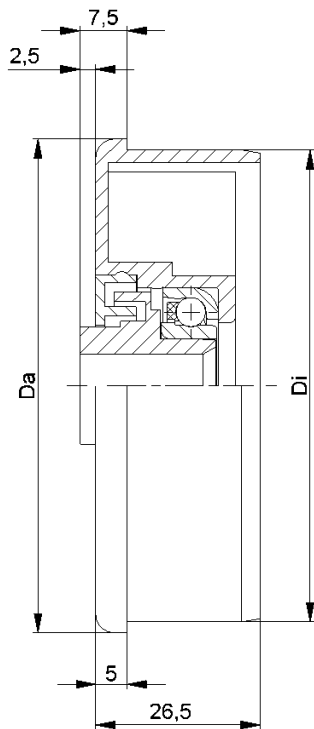

**KTR-31**

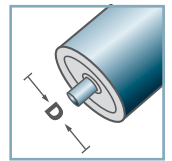

**D** [mm]  
80

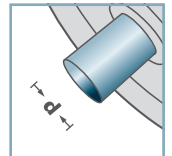

**d** [mm]  
12; 15; SW11



**C** [daN]  
25

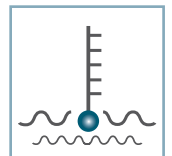

**T** [°C]  
0° - 80°



Vactra No. 2



**Karton** [Stck.]

100

<b>KTR-31</b>			
<b>Typ</b>	<b>Di +0,2</b>	<b>Da</b>	<b>Tragzahl C [daN]</b>
KTR-80x2,0.31	76,3	79,9	25

**Weitere Varianten auf Anfrage!**

- ☛ Radkörper: Kunststoff
- ☛ Innenlabyrinth: Kunststoff
- ☛ Außenlabyrinth: Kunststoff
- ☛ Kugellager RL-31
  - ☛ Lagerschale: 1.4301
  - ☛ Innenring: 1.4305
  - ☛ Kugelkäfig: Kunststoff
  - ☛ Kugel: 1.4301

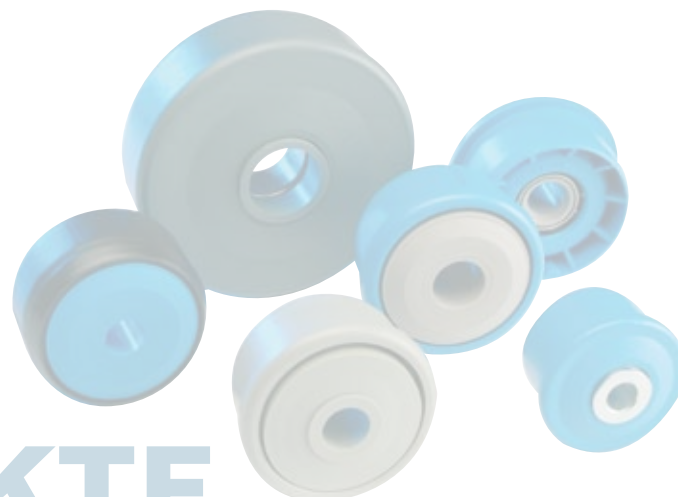

**KTR/KTE**

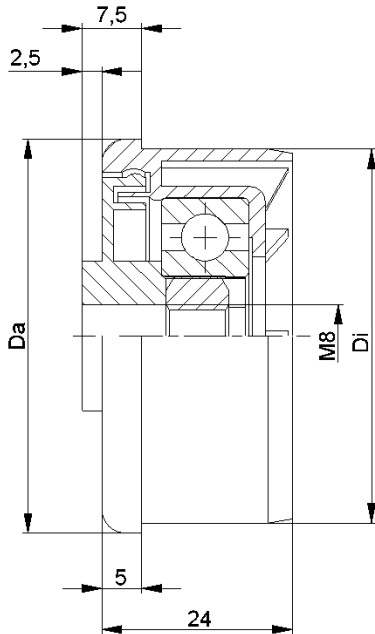

KTR-40			
Typ	Di +0,2	Da	Tragzahl C [daN]
KTR-50x1,5.40	47,3	49,9	80
KTR-60x1,5.40	57,3	59,9	80

**Weitere Varianten auf Anfrage!**

- ☛ Radkörper: Kunststoff
- ☛ Einfachlabyrinth: Kunststoff
- ☛ Kugellager 6202
- ☛ Sechskantmutter

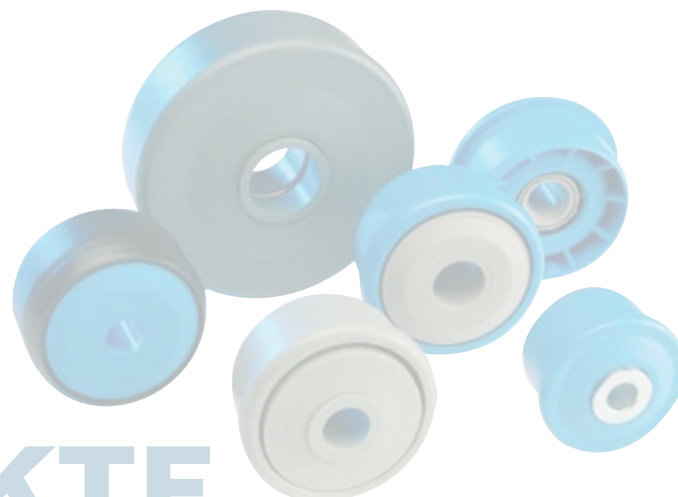

**KTR-40**

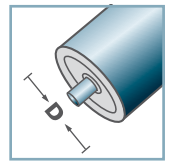

**D** [mm]  
50 - 60

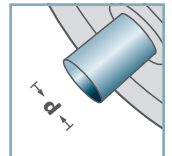

**d** [mm]  
M8



**C** [daN]  
80

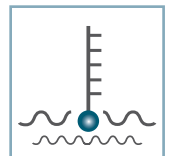

**T** [°C]  
0° - 80°



EP 2



**Karton** [Stck.]  
ø50: 250  
ø60: 100

**KTR/KTE**

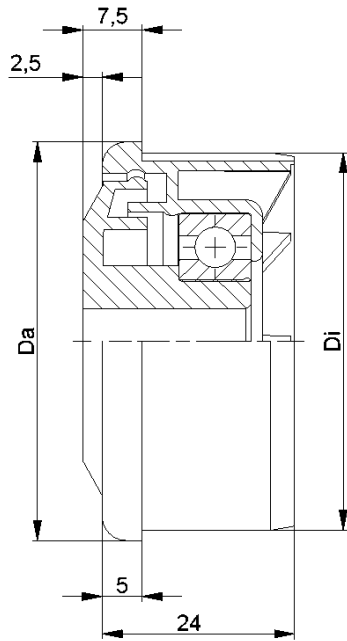

KTR-42			
Typ	Di +0,25	Da	Tragzahl C [daN]
KTR-50x1,5.42	47,3	49,9	80
KTR-50x2,0.42	46,3	49,9	80
KTR-50x2,8.42	44,6	49,9	80
KTR-60x1,5.42	57,3	59,9	80
KTR-60x2,0.42	56,3	59,9	80

**Weitere Varianten auf Anfrage!**

- ☛ Radkörper: Kunststoff
- ☛ Einfachlabyrinth: Kunststoff
- ☛ Kugellager 6002

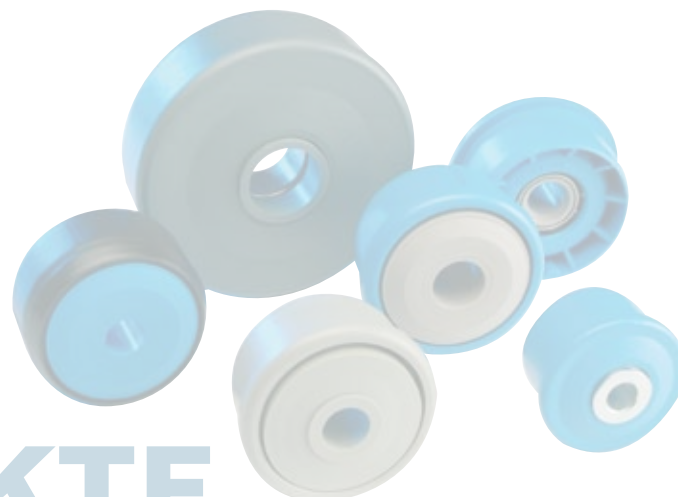

**KTR-42**

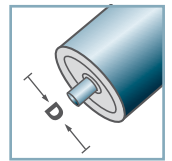

**D** [mm]  
50 - 60

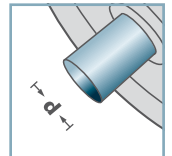

**d** [mm]  
10; 12; 14; 15;  
SW11



**C** [daN]  
80

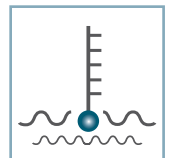

**T** [°C]  
0° - 80°



EP 2



**Karton** [Stck.]  
ø50: 250  
ø60: 100

**KTR/KTE**

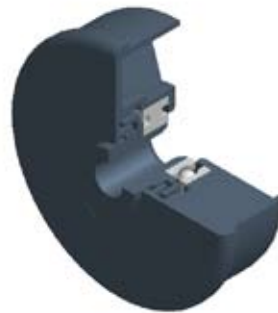
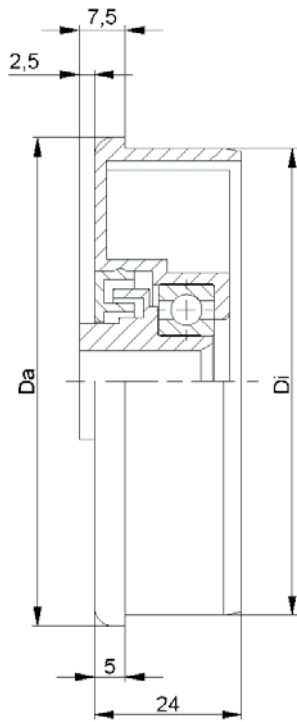

**KTR-42**

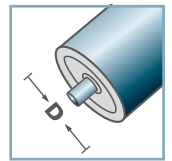

**D** [mm]  
80

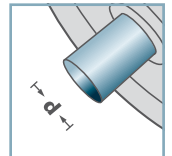

**d** [mm]  
12; 15; SW11



**C** [daN]  
150

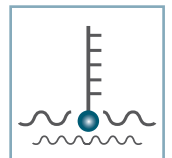

**T** [°C]  
0° - 80°



EP 2



**Karton** [Stck.]

100

<b>KTR-42</b>			
<b>Typ</b>	<b>Di +0,2</b>	<b>Da</b>	<b>Tragzahl C [daN]</b>
KTR-80x2,0.42	76,3	79,9	150
KTR-80x3,0.42	74,3	79,9	150

**Weitere Varianten auf Anfrage!**

- ☛ Radkörper: Kunststoff
- ☛ Innenlabyrinth: Kunststoff
- ☛ Außenlabyrinth: Kunststoff
- ☛ Kugellager 6002

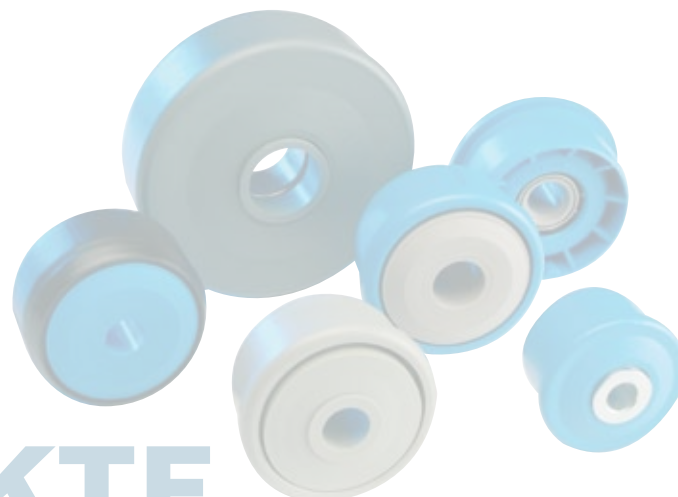

**KTR/KTE**



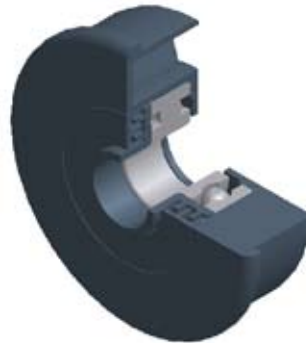
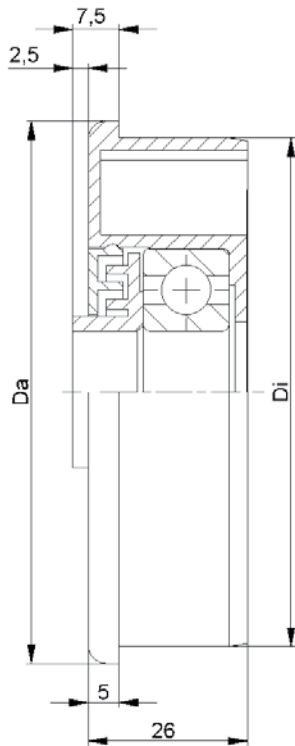

**KTR-44**

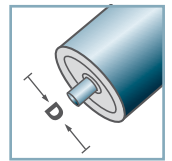

**D** [mm]  
89

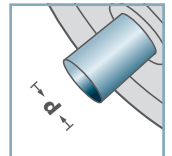

**d** [mm]  
20



**C** [daN]  
150

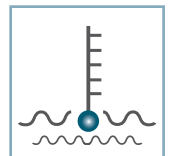

**T** [°C]  
0° - 80°



EP 2



**Karton** [Stck.]

80

**KTR-44**

Typ	Di +0,2	Da	Tragzahl C [daN]
KTR-89x3,0.44	83,3	88,9	150

**Weitere Varianten auf Anfrage!**

- ☛ Radkörper: Kunststoff
- ☛ Innenlabyrinth: Kunststoff
- ☛ Außenlabyrinth: Kunststoff
- ☛ Kugellager 6204

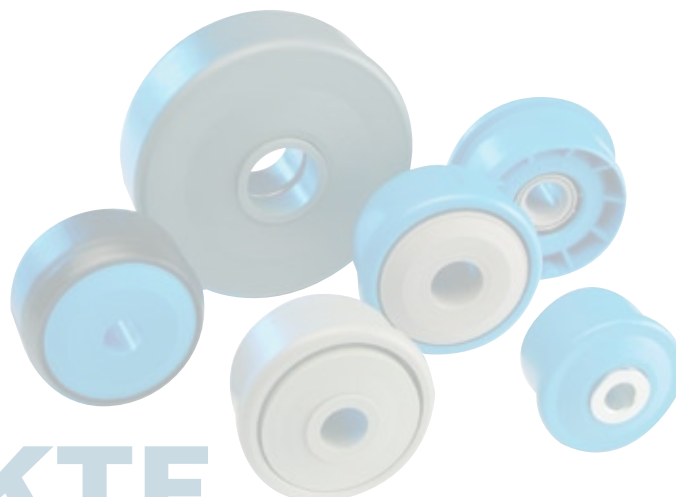

**KTR/KTE**

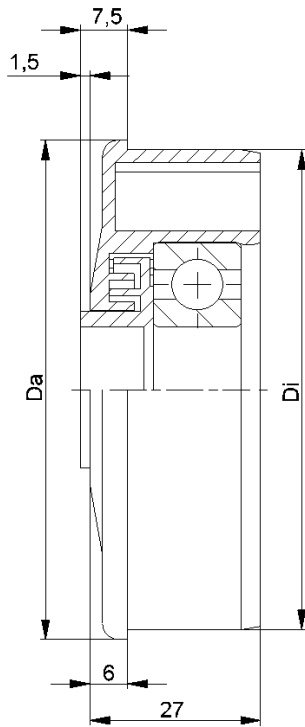

KTR-44			
Typ	Di +0,2	Da	Tragzahl C [daN]
KTR-63,5x2,9.44	58,0	63,4	150
KTR-80x2,0.44	76,4	79,9	150

**Weitere Varianten auf Anfrage!**

- ☛ Radkörper: Kunststoff
- ☛ Mehrfachlabyrinth: Kunststoff
- ☛ Kugellager 6204

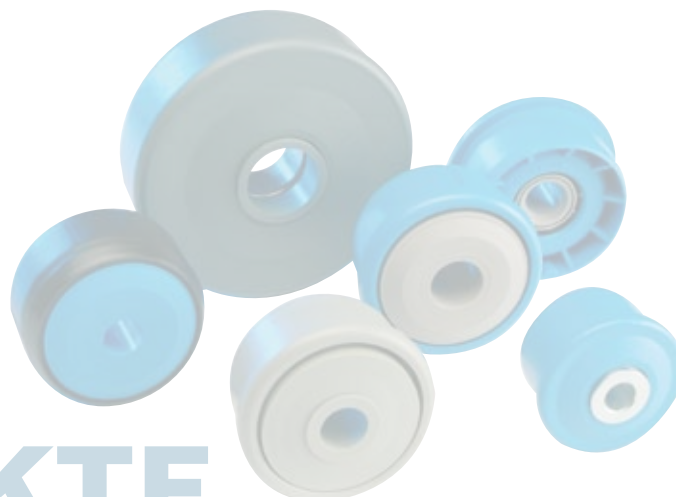

**KTR-44**

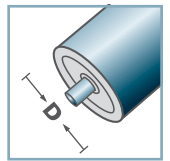

**D** [mm]  
63,5 - 80

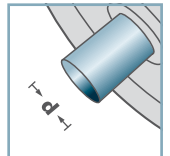

**d** [mm]  
20



**C** [daN]  
150

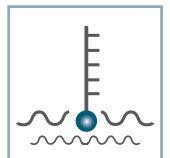

**T** [°C]  
0° - 80°



EP 2



**Karton** [Stck.]  
100

**KTR/KTE**

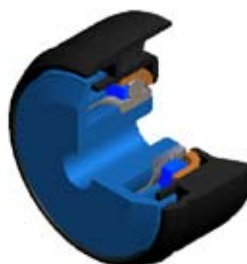
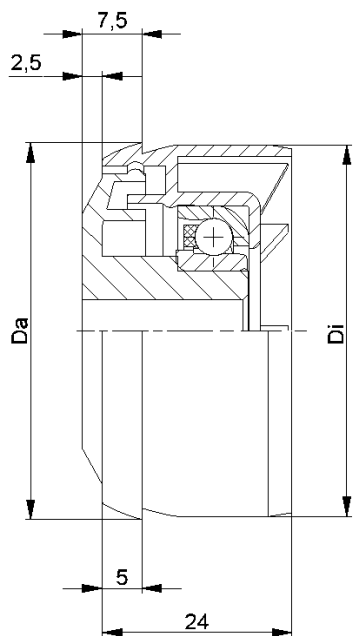

KTE-30			
Typ	Di +0,3	Da	Tragzahl C [daN]
KTE-50x1,5.30	47,1	47,9	80

**Weitere Varianten auf Anfrage!**

- ☛ Radkörper: Kunststoff
- ☛ Einfachlabyrinth: Kunststoff
- ☛ Kugellager RL-30
  - ☛ Lagerschale: Stahl, gehärtet
  - ☛ Innenring: Stahl, gehärtet
  - ☛ Kugelkäfig: Kunststoff
  - ☛ Kugel: Stahl

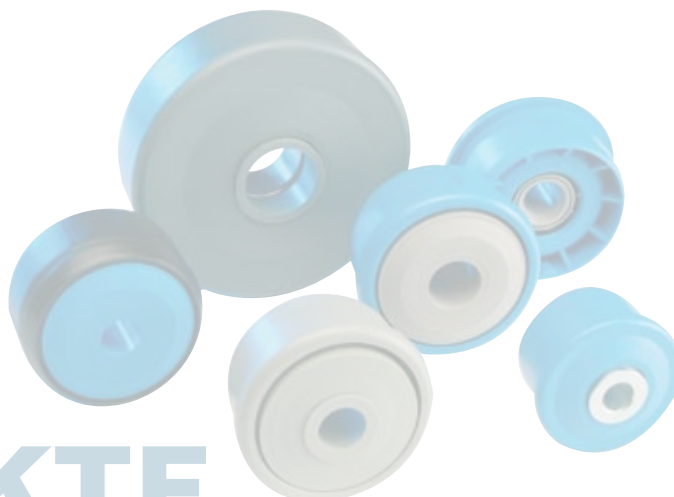

**KTE-30**

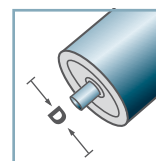

**D** [mm]  
50

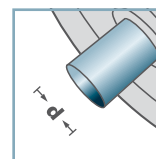

**d** [mm]  
10; 12; 14; 15;  
SW11

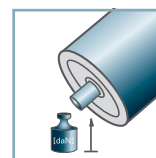

**C** [daN]  
80

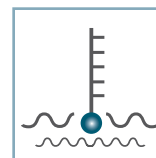

**T** [°C]  
0° - 80°



Vactra No. 2



**Karton** [Stck.]

250

**KTR/KTE**

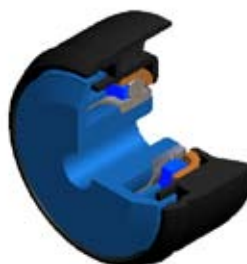
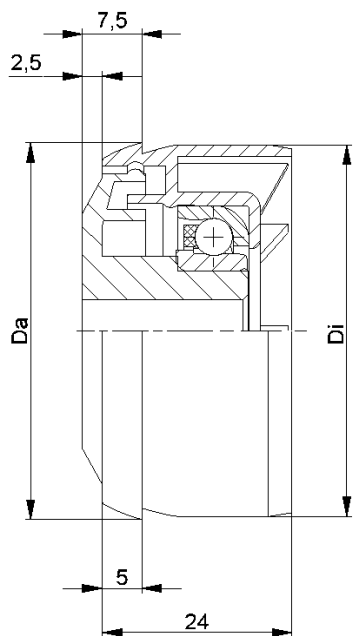

KTE-31			
Typ	Di +0,3	Da	Tragzahl C [daN]
KTE-50x1,5.31	47,1	47,9	25

Weitere Varianten auf Anfrage!

- ☛ Radkörper: Kunststoff
- ☛ Einfachlabyrinth: Kunststoff
- ☛ Kugellager RL-31
  - ☛ Lagerschale: 1.4301
  - ☛ Innenring: 1.4305
  - ☛ Kugelkäfig: Kunststoff
  - ☛ Kugel: 1.4301

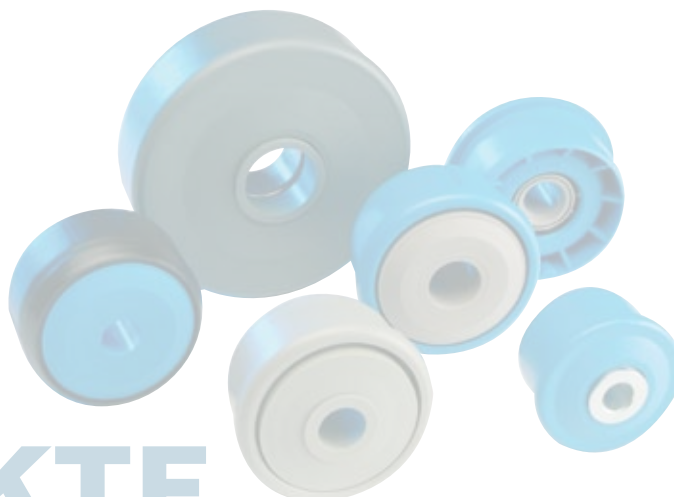

KTE-31

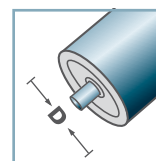

D [mm]  
50

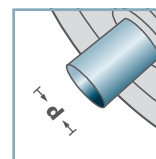

d [mm]  
10; 12; 14; 15;  
SW11

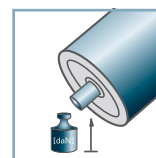

C [daN]  
25

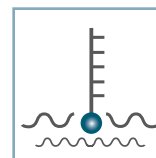

T [°C]  
0° - 80°



Vactra No. 2



Karton [Stck.]

250

KTR/KTE

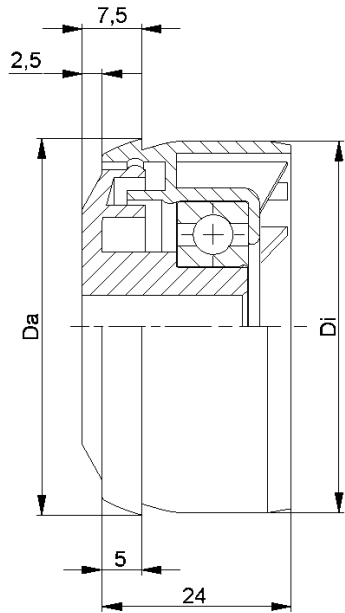

KTE-42			
Typ	Di +0,3	Da	Tragzahl C [daN]
KTE-50x1,5.42	47,1	47,9	80

**Weitere Varianten auf Anfrage!**

- ☛ Radkörper: Kunststoff
- ☛ Einfachlabyrinth: Kunststoff
- ☛ Kugellager 6002

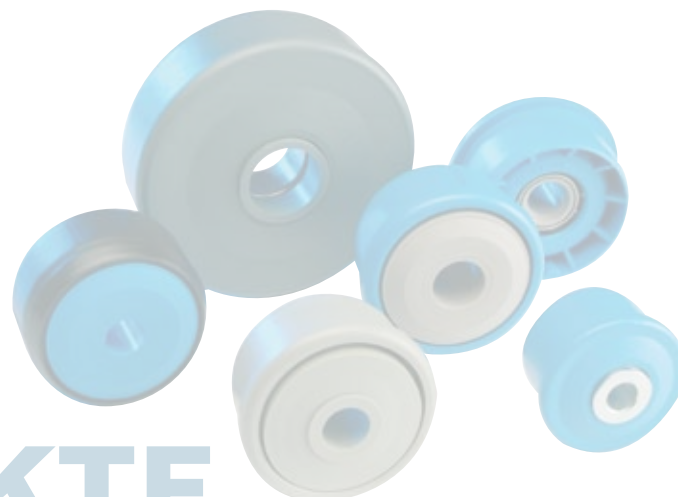

**KTE-42**

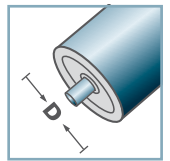

**D** [mm]  
50

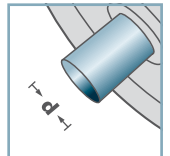

**d** [mm]  
10; 12; 14; 15;  
SW11



**C** [daN]  
80

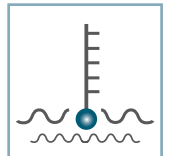

**T** [°C]  
0° - 80°



EP 2



**Karton** [Stck.]

250