

KTR-16.00  
KTR-16.01

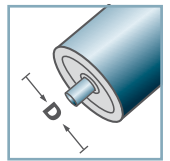

**D** [mm]  
16

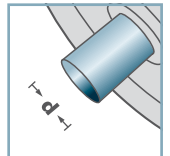

**d** [mm]  
5; 6



**C** [daN]  
3

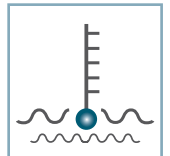

**T** [°C]  
0° - 80°



**KTR-16.00/.01**

Typ	Normal .00	Niro .01	Di +0,15	Da	Tragzahl C [daN]
KTR-16x1,0	x	x	14,1	15,9	3

**Weitere Varianten auf Anfrage!**

- ☛ Radkörper: Kunststoff
- ☛ Nabe: Kunststoff
- ☛ Kugel
  - ☛ 00: Stahl
  - ☛ 01: 1.4034



**Karton** [Stck.]

500

KTR-20.00  
KTR-20.01

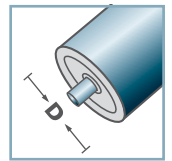
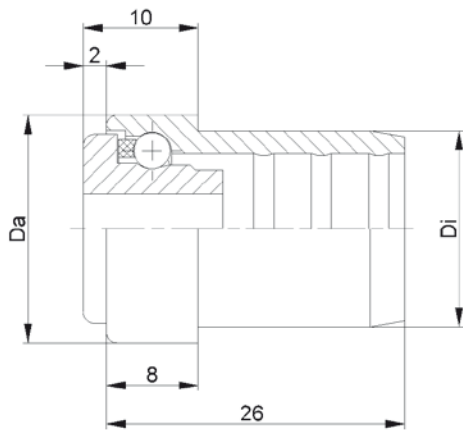

**D** [mm]  
20

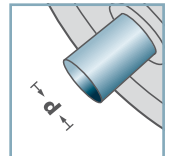

**d** [mm]  
6; 8



**C** [daN]  
5

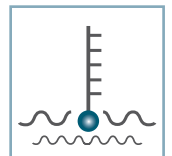

**T** [°C]  
0° - 80°



**KTR-20.00/.01**

Typ	Normal .00	Niro .01	Di +0,15	Da	Tragzahl C [daN]
KTR-20x1,0	x	x	18,1	19,9	5
KTR-20x1,5	x	x	17,1	19,9	5

**Weitere Varianten auf Anfrage!**

- ☛ Radkörper: Kunststoff
- ☛ Nabe: Kunststoff
- ☛ Käfig: Kunststoff
- ☛ Kugel
  - ☛ 00: Stahl
  - ☛ 01: 1.4034

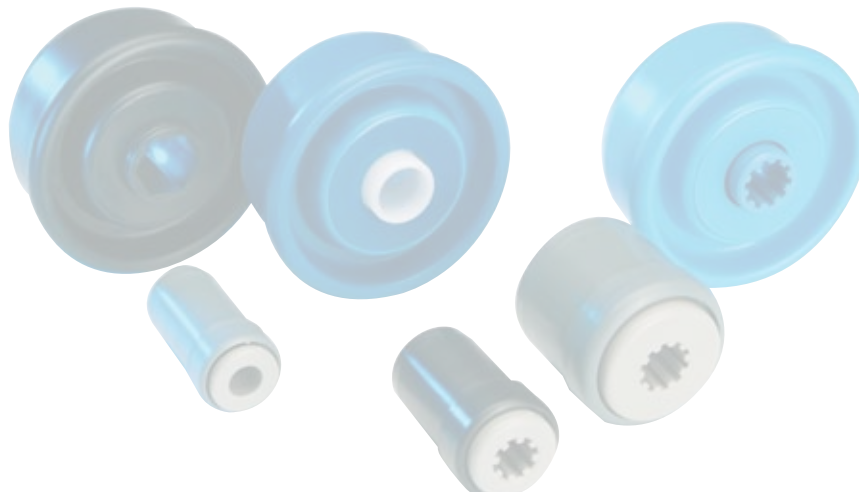

**Karton** [Stck.]

1000

**KTR**

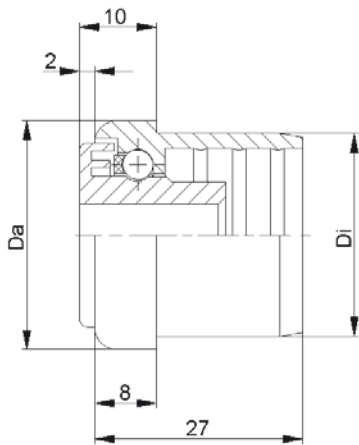

**KTR-30.00**  
**KTR-30.01**

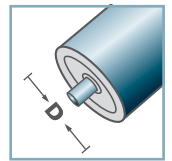

**D** [mm]  
30

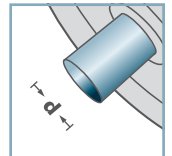

**d** [mm]  
6; 8; 10



**C** [daN]  
7

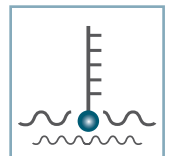

**T** [°C]  
0° - 80°



KTR-30.00/.01					
Typ	Normal .00	Niro .01	Di +0,25	Da	Tragzahl C [daN]
KTR-30x1,0	x	x	28,1	29,9	7
KTR-30x1,5	x	x	27,1	29,9	7
KTR-30x1,8	x	x	26,5	29,9	7
KTR-30x2,0	x	x	26,35	29,9	7

### Weitere Varianten auf Anfrage!

- ☛ Radkörper: Kunststoff
- ☛ Nabe: Kunststoff
- ☛ Käfig: Kunststoff
- ☛ Kugel
  - ☛ 00: Stahl
  - ☛ 01: 1.4034

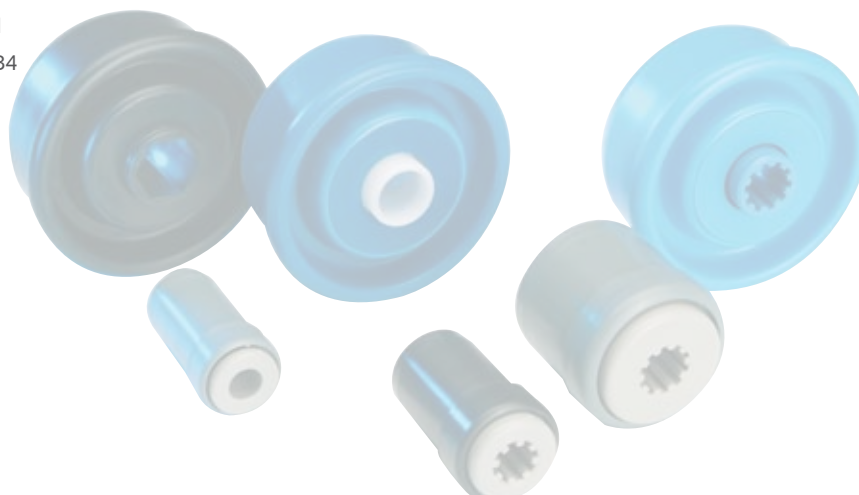

**Karton** [Stck.]

250

# KTR

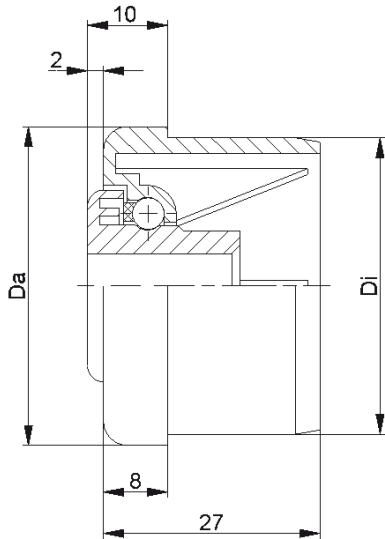

KTR-40.00  
KTR-40.01

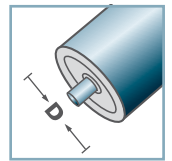

D [mm]  
40

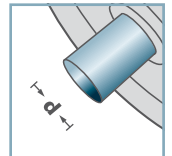

d [mm]  
6; 8; 10



C [daN]  
7

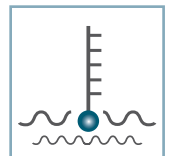

T [°C]  
0° - 80°



**KTR-40.00/.01**

Typ	Normal .00	Niro .01	Di +0,25	Da	Tragzahl C [daN]
KTR-40x1,5	x	x	37,1	39,9	7
KTR-40x2,3	x	x	35,5	39,9	7

**Weitere Varianten auf Anfrage!**

- ☛ Radkörper: Kunststoff
- ☛ Nabe: Kunststoff
- ☛ Käfig: Kunststoff
- ☛ Kugel
  - ☛ 00: Stahl
  - ☛ 01: 1.4034

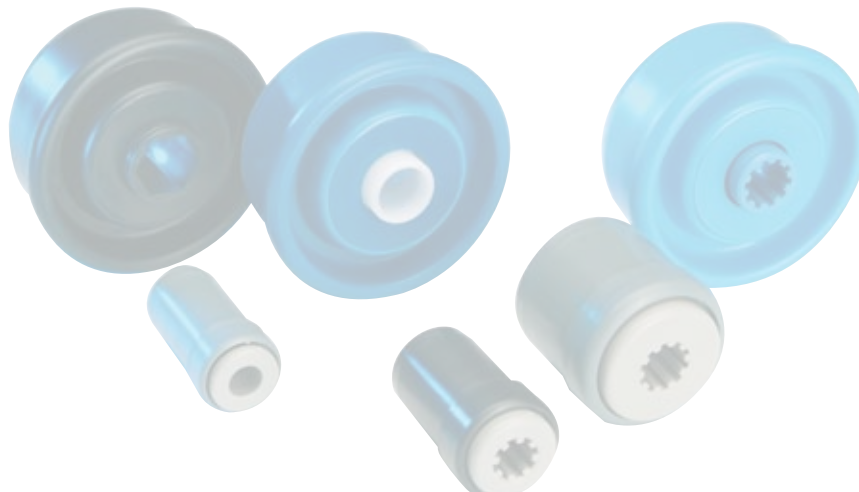

Karton [Stck.]

250

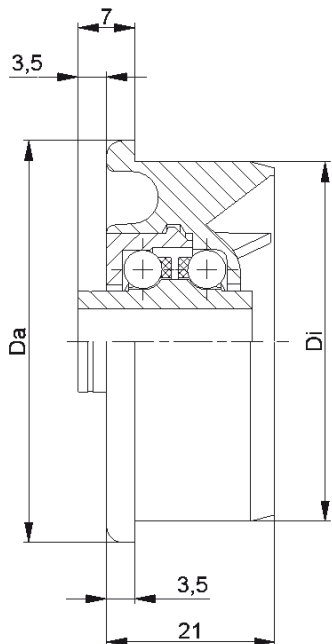

KTR-02/03					
Typ	Normal .02	Niro .03	Di +0,2	Da	Tragzahl C [daN]
KTR-50x1,5	x	x	47,3	49,9	10
KTR-50x2,0	x	x	46,3	49,9	10
KTR-50x2,8	x	x	44,6	49,9	10

### Weitere Varianten auf Anfrage!

- ☛ Radkörper: Kunststoff
- ☛ Nabe: Kunststoff
- ☛ Lagerdeckel: Kunststoff
- ☛ Käfig: Kunststoff
- ☛ Kugel
  - ☛ 02: Stahl
  - ☛ 03: 1.4034



### KTR-02 KTR-03

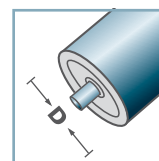

**D** [mm]  
50

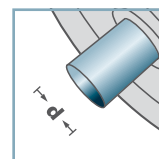

**d** [mm]  
8; 10

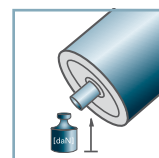

**C** [daN]  
10

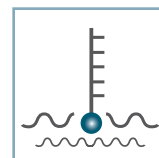

**T** [°C]  
0° - 80°



**Karton** [Stck.]

50x1,5: 250  
50x2,0: 300  
50x2,8: 250

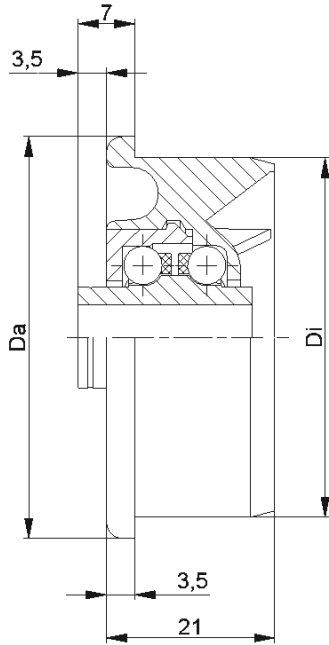

KTR-02/03					
Typ	Normal .02	Niro .03	Di +0,2	Da	Tragzahl C [daN]
KTR-50x1,5	x	x	47,3	49,9	10
KTR-50x2,8	x	x	44,6	49,9	10

**Weitere Varianten auf Anfrage!**

- ☛ Radkörper: Kunststoff
- ☛ Nabe: Kunststoff
- ☛ Lagerdeckel: Kunststoff
- ☛ Käfig: Kunststoff
- ☛ Kugel
  - ☛ 02: Stahl
  - ☛ 03: 1.4034

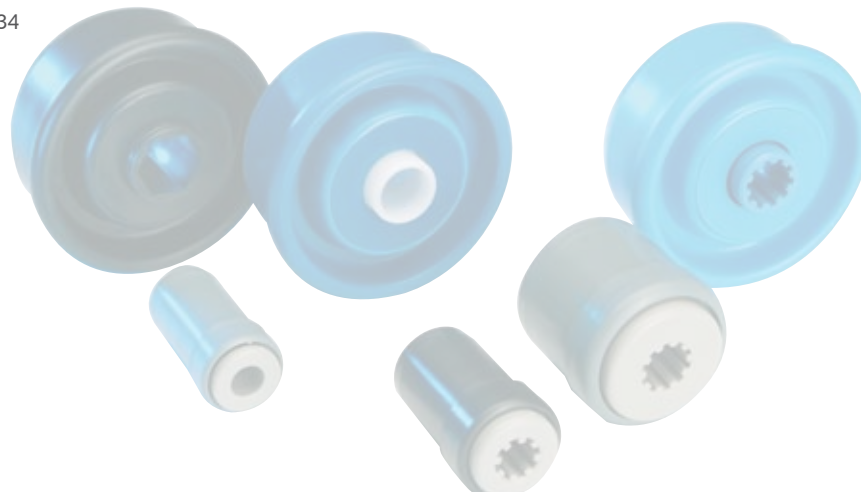

**KTR-02  
KTR-03**

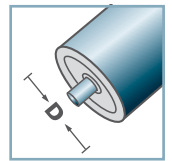

**D** [mm]  
50

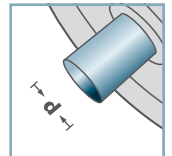

**d** [mm]  
12; SW11



**C** [daN]  
10

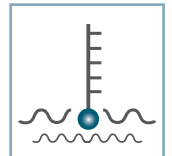

**T** [°C]  
0° - 80°



**Karton** [Stck.]

250

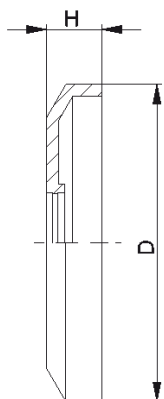

DK-KTR		
Typ	D	H
DK-KTR-02	40,5	7

Weitere Varianten auf Anfrage!

☛ Dichtkappe: Kunststoff

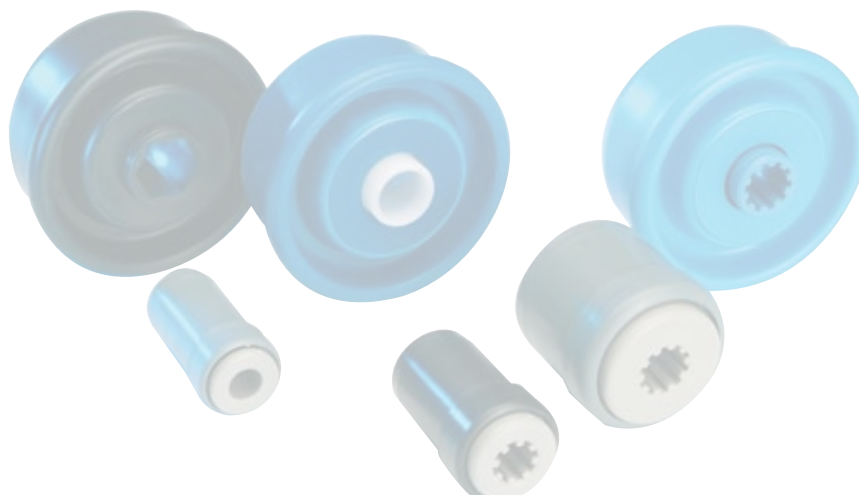

DK-KTR-02

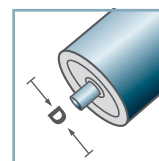

D [mm]

-

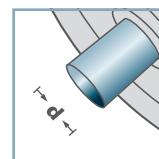

d [mm]

-

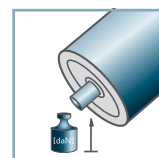

C [daN]

-

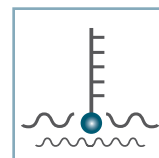

T [°C]

0° - 80°



-



Karton [Stck.]

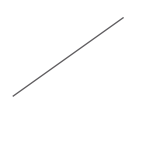

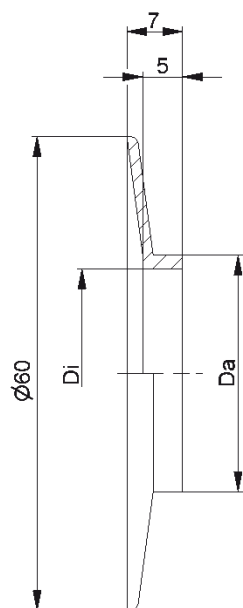

BS-		
Typ	Di	Da
BS-30x1,0	28,1	29,9
BS-30x1,8	26,5	29,9
BS-40x1,5	37,1	39,9
BS-40x2,3	35,5	39,9

Weitere Varianten auf Anfrage!

☛ Bordscheibe: Kunststoff

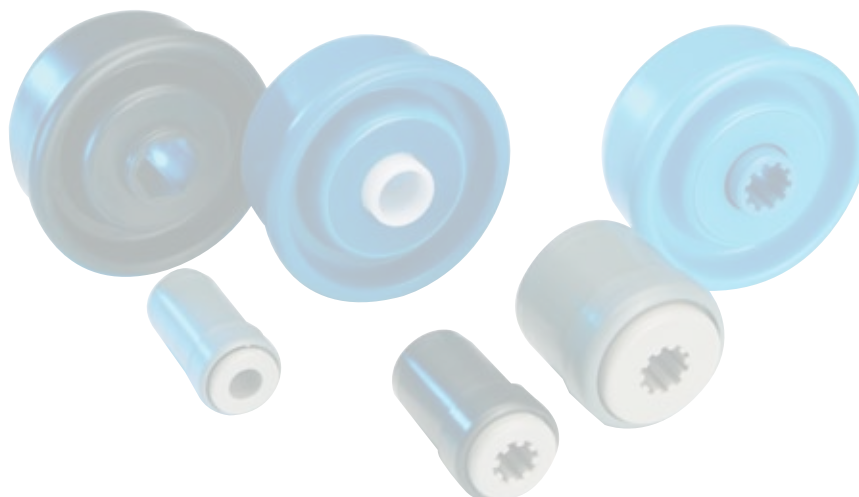

BS-

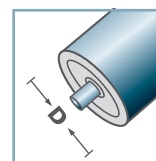

D [mm]

-

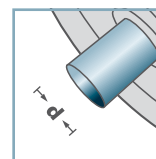

d [mm]

-

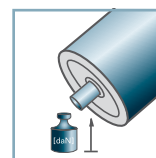

C [daN]

-

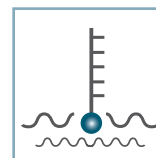

T [°C]

0° - 80°



-



Karton [Stck.]

